

CRANK OPERATED ROLLING SHUTTER

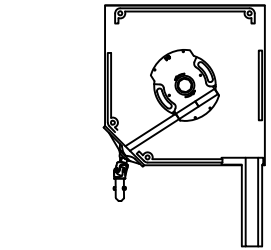

UNIVERSAL MOUNTED OUTSIDE ON 45 DEGREE.

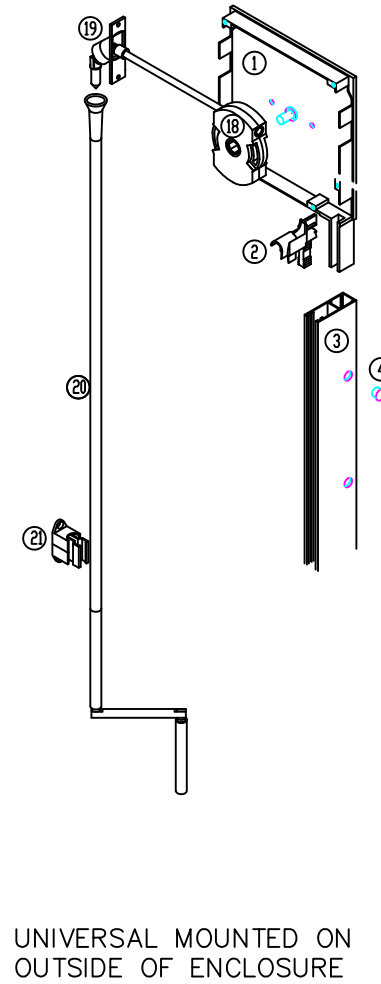
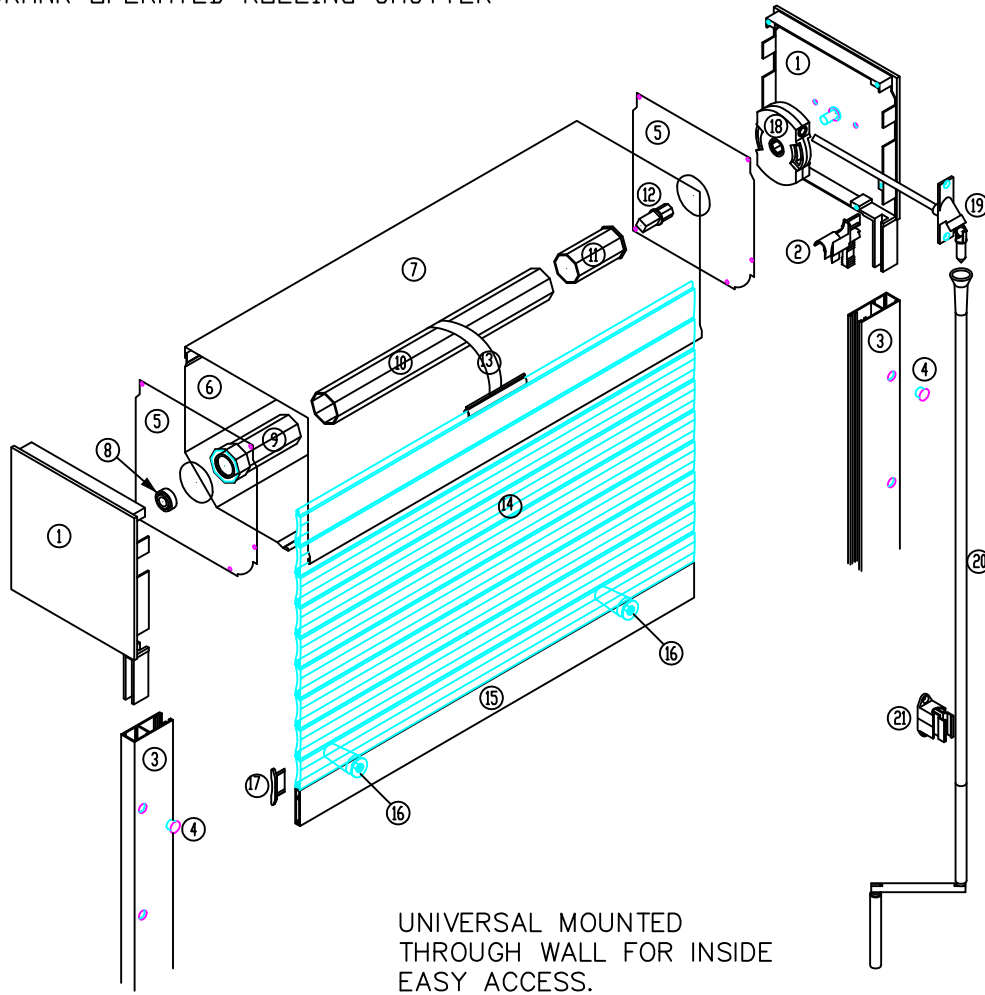
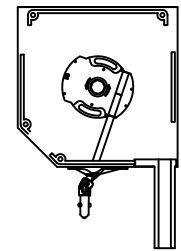

UNIVERSAL MOUNTED OUTSIDE AT BOTTOM OF ENCLOSURE

- ① Side/End Cap
- ② Entry Guide
- ③ Guide Rail With 3cm Cut
- ④ Plug Button
- ⑤ Safety Plate
- ⑥ Housing (Front/Bottom) 4"-10"
- ⑦ Housing (Top/Back) 4"-10"

- ⑧ Ball Bearing
- ⑨ Idler Insert (PVC)
- ⑩ 40/60 mm Axle (Galvanized/Aluminum)
- ⑪ Gear Insert
- ⑫ Gear Connector
- ⑬ Springlock Hanger
- ⑭ Aluminum or PVC Slat

- ⑮ Base Slat
- ⑯ Exterior Nylon Stop
- ⑰ Side Lock
- ⑱ Gear
- ⑲ Universal
- ⑳ Crank Handle
- ㉑ Crank Holder (Optional)



1-866-783-2105